

EVVOSEMI[®]

THINK CHANGE DO



ESD



TVS



MOS



LDO



Diode



Sensor



DC-DC

Product Specification

| | | |
|--------------|-------------|----------------|
| ▶ Domestic | Part Number | LESD8D7.0CAT5G |
| ▶ Overseas | Part Number | LESD8D7.0CAT5G |
| ▶ Equivalent | Part Number | LESD8D7.0CAT5G |

EV is the abbreviation of name EVVO

General Description

The LESD8D7.0CAT5G is designed to protect voltage sensitive components from ESD and transient voltage events. Excellent clamping capability, low leakage, and fast response time, make these parts ideal for ESD protection on designs where board space is at a premium.

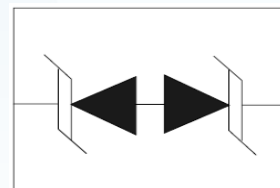

Features

- Small Body Outline Dimensions
- Low Body Height
- Peak Power up to 80Watts @ 8 x 20μ s Pulse
Low Leakage
- Response Time is Typically < 1 ns
- ESD Rating of Class 3 (> 16 kV) per Human Body Model
- IEC61000-4-2 Level 4 ESD Protection
- IEC61000-4-4 Level 4 EFT Protection
- We declare that the material of product compliance with RoHS requirements.

Applications

- Cellular phones
- Portable devices
- Digital cameras
- Power supplies

Absolute Ratings (T_{amb}=25°C)

| Symbol | Parameter | Value | Units |
|------------------|---|--|-------|
| P _{PP} | Peak Pulse Power (t _p = 8/20μs) | 80 | W |
| T _L | Maximum lead temperature for soldering during 10s | 260 | °C |
| T _{stg} | Storage Temperature Range | -55 to +150 | °C |
| T _{op} | Operating Temperature Range | -40 to +125 | °C |
| T _j | Maximum junction temperature | 150 | °C |
| | IEC61000-4-2 (ESD) | air discharge ±20 contact discharge ±15 | KV |
| | IEC61000-4-4 (EFT) | 40 | A |
| | ESD Voltage | Per Human Body Model 16 | KV |

Electrical Characteristics Ratings at 25°C ambient temperature unless otherwise specified. $V_F = 0.9V$ at $I_F = 10mA$

| Device | V_{RWM} (V) | $I_R(\mu A)$ @ V_{RWM} | V_{BR} (V) @ I_T (Note 1) | I_T | V_C (V) @ $I_{PP}=3 A^*$ | V_C (V) @ Max I_{PP}^* | I_{PP} (A)* | P_{PK} (W)* | C (pF) |
|----------------|------------------|-----------------------------|----------------------------------|-------|-------------------------------|-------------------------------|------------------|------------------|-------------|
| | Max | Max | Min | mA | Typ | Max | Max | Max | Typ |
| LESD8D7.0CAT5G | 7.0 | 1.0 | 7.2 | 1.0 | 13 | 16 | 5 | 80 | 16 |

*Surge current waveform per Figure 2.

1. V_{BR} is measured with a pulse test current I_T at an ambient temperature of 25 °C.

Electrical Parameter

| Symbol | Parameter |
|-----------|---|
| I_{PP} | Maximum Reverse Peak Pulse Current |
| V_C | Clamping Voltage @ I_{PP} |
| V_{RWM} | Working Peak Reverse Voltage |
| I_R | Maximum Reverse Leakage Current @ V_{RWM} |
| I_T | Test Current |
| V_{BR} | Breakdown Voltage @ I_T |
| I_F | Forward Current |
| V_F | Forward Voltage @ I_F |

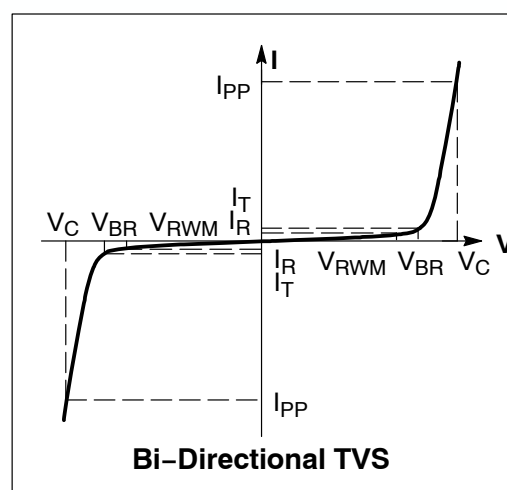

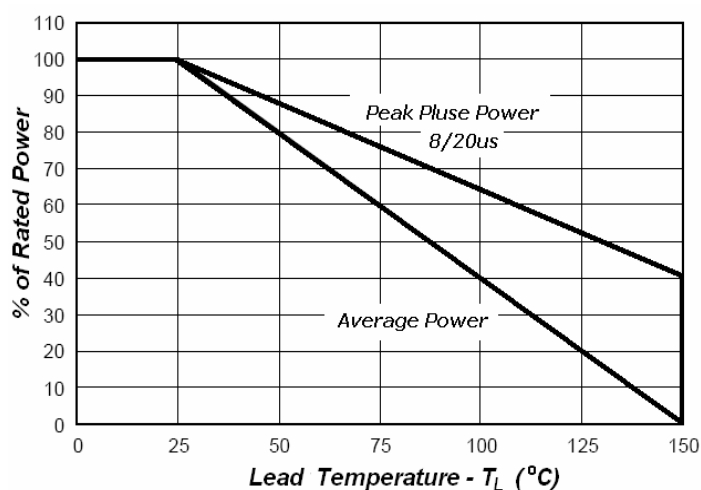
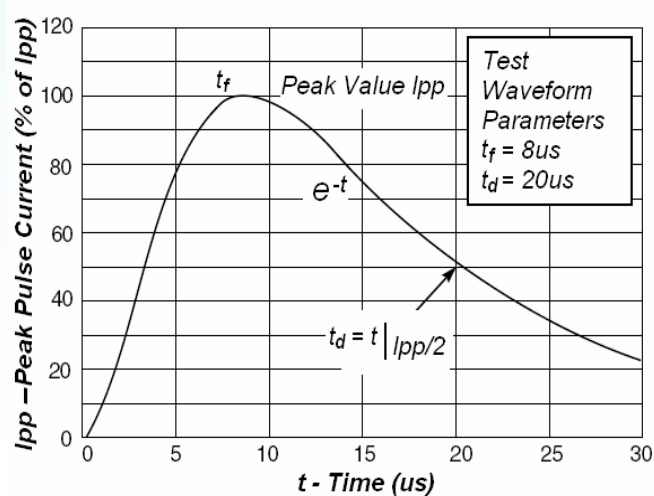
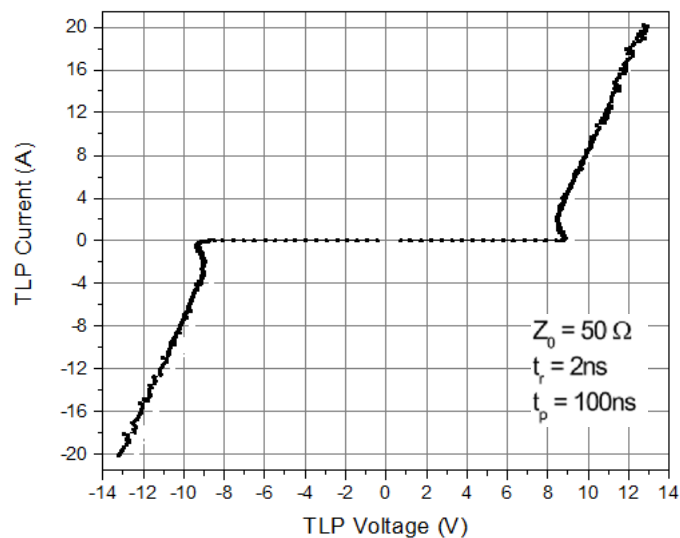

SOD-882 PACKAGE OUTLINE DIMENSIONS

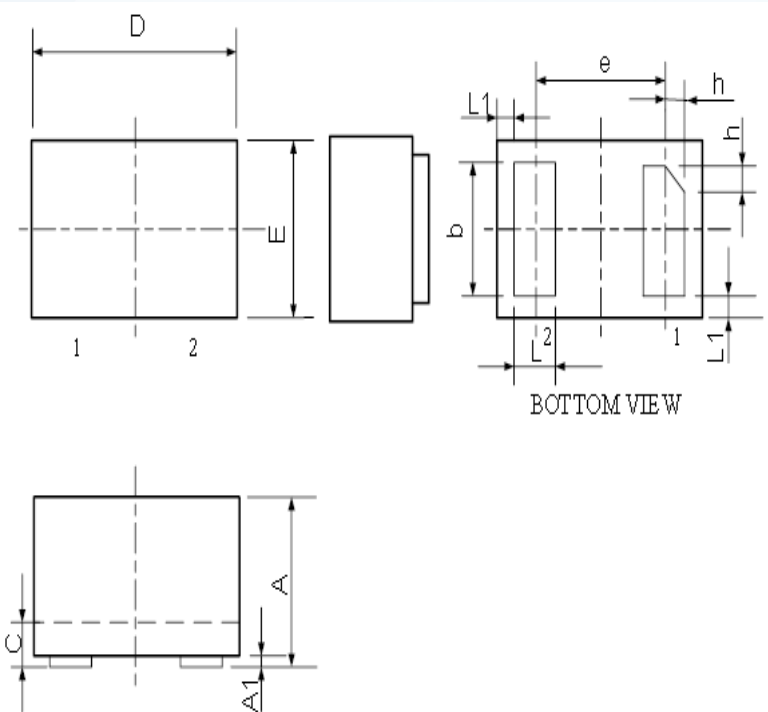

| Symbol | Dimensions In Millimeters | |
|--------|---------------------------|---------|
| | Minimum | Maximum |
| A | 0.450 | 0.550 |
| A1 | 0.000 | 0.050 |
| b | 0.45 | 0.55 |
| C | 0.12 | 0.18 |
| D | 0.950 | 1.050 |
| e | 0.65BSC | |
| E | 0.550 | 0.650 |
| L | 0.200 | 0.300 |
| L1 | 0.05REF | |
| h | 0.07 | 0.17 |

Marking

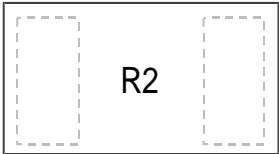

Ordering information

| Order code | Package | Baseqty | Deliverymode |
|----------------|---------|---------|---------------|
| LESD8D7.0CAT5G | SOD-882 | 10000 | Tape and reel |

Disclaimer

EVVOSEMI ("EVVO") reserves the right to make corrections, enhancements, improvements, and other changes to its products and services at any time, and to discontinue any product or service without notice.

EVVO warrants the performance of its hardware products to the specifications applicable at the time of sale in accordance with its standard warranty. Testing and other quality control techniques are used as deemed necessary by EVVO to support this warranty. Except where mandated by government requirements, testing of all parameters of each product is not necessarily performed.

Customers should obtain and confirm the latest product information and specifications before final design, purchase, or use. EVVO makes no warranty, representation, or guarantee regarding the suitability of its products for any particular purpose, nor does EVVO assume any liability for application assistance or customer product design. EVVO does not warrant or accept any liability for products that are purchased or used for any unintended or unauthorized application.

EVVO products are not authorized for use as critical components in life support devices or systems without the express written approval of EVVOSEMI.

The EVVO logo and EVVOSEMI are trademarks of EVVOSEMI or its subsidiaries in relevant jurisdictions. EVVO reserves the right to make changes without further notice to any products herein.